

SPECIFICATION

10.1" Capacitive Touch PC

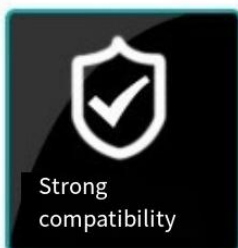

FEATURE

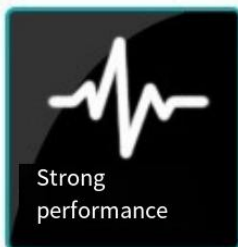
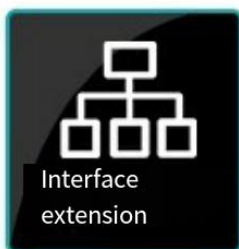

FEATURE



- Edge-to-edge glass IP67 rated
- Complete waterproofing, Touch waterproofing
- 10-finger multitouch touch screen Panel;
- 2.5D Panel design
- RK3566/2G/16G/
- 2GB RAM 16GB SSD included
- 32Bit and 64Bit support, Android 11
- Integrated Wi-Fi, 1 × LAN
- light strip, High brightness optional
- NFC/GPS /wifi/4G
- VESA 75 bracket for mounting, metal stand included
- Customization available upon request

PRODUCT PICTURE



front



back



side



side



interface



Top

Package&accessories



airplane box



glue stick antenna



power wire



Power adapter supply



bracket

产品参数

PRODUCT PARAMETERS

Anti-glare LCD Panel	
IP rated front panel	IP67
Screen diagonal (Inch/cm):	10.1/25.65
Display active screen size:	21.70x13.60mm
Aspect ratio:	16:10
Physical resolution:	1280x800
Colours displayed:	16M
Brightness (cd/m2):	350 (Highlight optional 1000nits)
Contrast:	800:1
Typical reaction time Tr/ Tf :	10/15 (ms)
Visual Angle horizontal/vertical :	170/170(°)
Backlight / Backlight Lifetime (hours):	LED / 30,000

Operation / Mechanical	
Operating Temperature	-20 ~ +70 (°C)
Humidity Range (RH)	10%-90%
Gross weight (kg)	2
Housing material	Aluminium
Housing (cm) LxWxH	28.4*17.5*3.55
Mounting	VESA 75

Power	
Power Indicator	Green LED
Power Supply	100-240V ACDC active switch- ing; 12V DC- Out
Working Power (V)	12
Power Consumption (W)	11
Stand-By Consumption (W)	<1

PC System	
CPU	RK3566
Memory	2G
Storage	16GGB
USB Port	1*USB 2.0 2*USB3.0
RS232	1*RS232 or 485
I/O	RJ45+HDMI
GPIO	Support 3 chanel GPIO
Wifi/Buletooth	Support
System	Android 11

产品尺寸图

PRODUCT DIMENSION

10.1' Capacitive Touch PC (16:10)

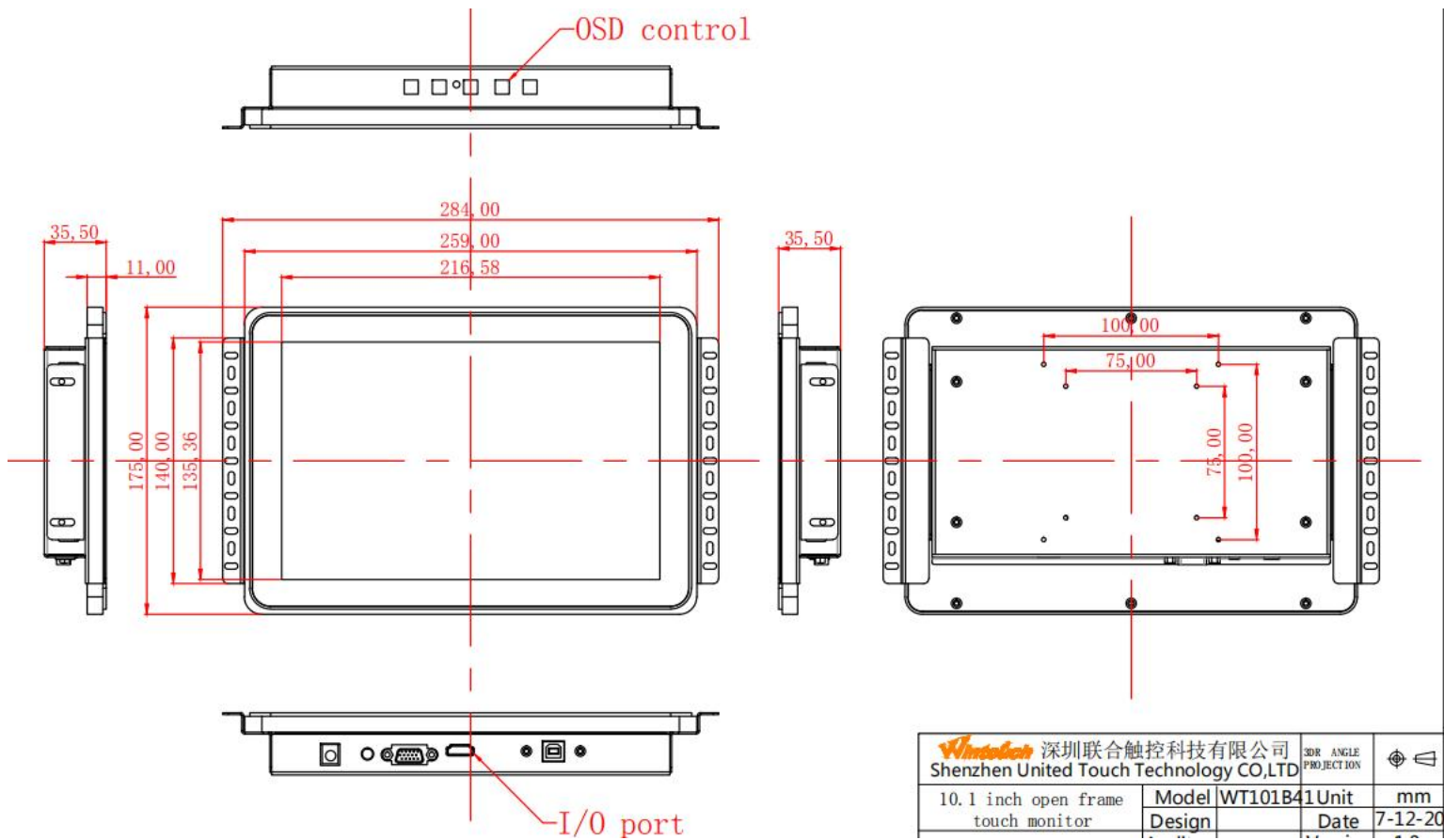

 深圳联合触控科技有限公司 Shenzhen United Touch Technology CO,LTD		30° ANGLE PROJECTION	
10.1 inch open frame touch monitor	Model WT101B41 Design	Unit Date	mm 7-12-20

工控五大应用领域

APPLICATION AREAS OF PRODUCTS

INDUSTRY APPLICATION CASES

According to the corresponding software version of each industry it is widely used in all walks of life



 Bank/ATM



 Car



 Building Automation



 Digital Signage



 Education/Office



 Mechanical Control Panel



 Medical



 Cashier



 Transportation

安装方式

WAY TO INSTALL

Embedded Installation

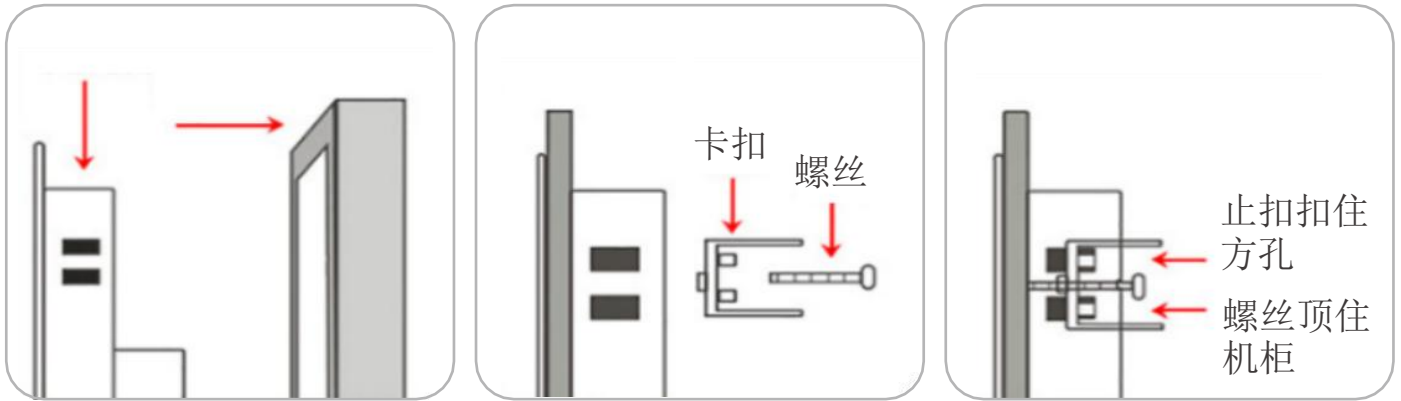

Fixed on table



Mount on the back

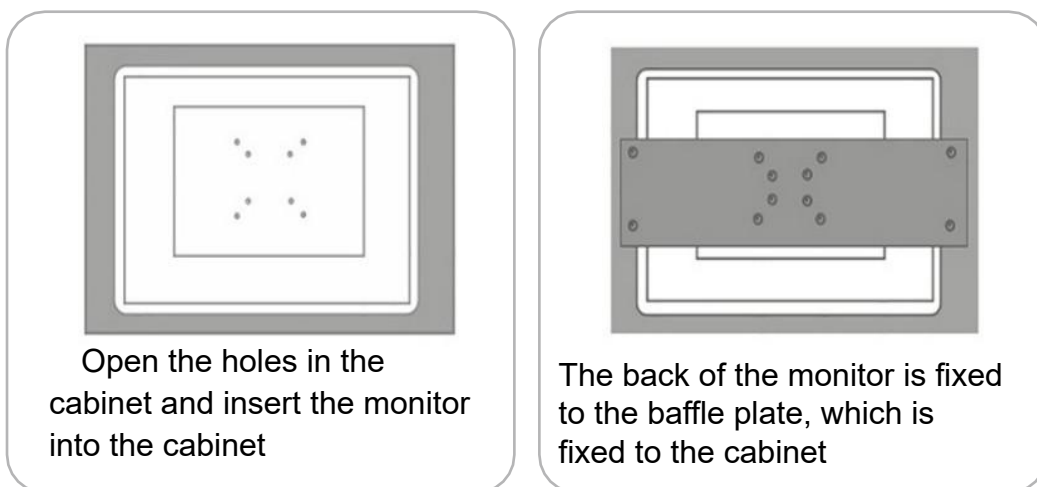

Wall mount installation

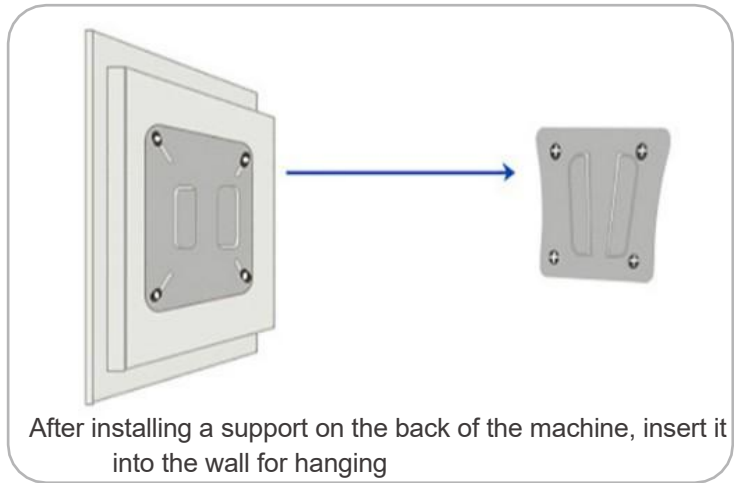
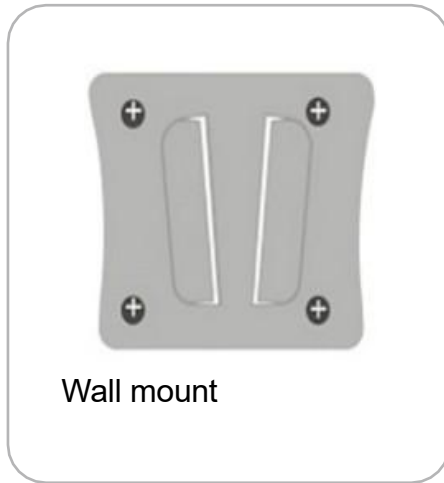

Iron mounting

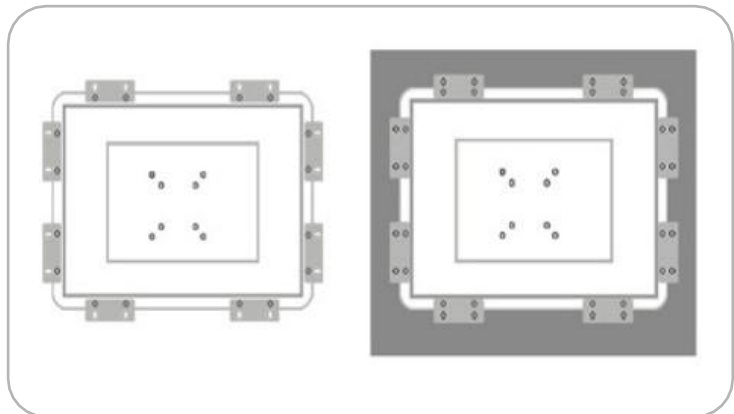
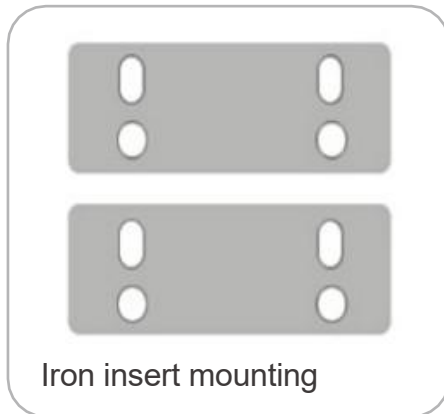

10 tests before Shipment



Screen detection

Test that the screen is in good condition before making



Dc voltage regulator test

Adjust the output voltage to achieve the purpose of stable voltage output



Withstand voltage test

Identification of electrical equipment insulation strength



Touch detection

Test whether the screen is sensitive to touch



Heat testing

Test if the all-in-one is up to standard in high temperatures



Thermostatic testing

Test whether the machine meets the standards under high temperature and strong humidity or low temperature and strong humidity environment



Vibration detection

Simulate whether the car can work normally under the condition of vibration

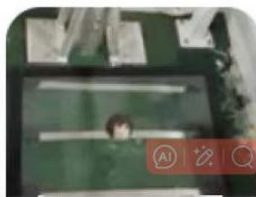

Drop test

Detect whether the car is broken when falling at a certain height



Electrostatic testing

Test whether contact with 4KV static electricity can work normally



Aging detection

Whether there will be a fault after 48 hours of power on